

Starwade Metal Products, Inc.
 6868 State Route 305 PD Box 10
 Hartford, Ohio 44424
 Phone: 800-826-5243 Fax: 1-330-772-3307
 www.tankstore.com

Tank for stationary use only

Capacity	300 Gallons	Heads Primary	10 Gauge	Paint Ext.	Red Primer
Design	AG Doublewall	Shell Primary	12 Gauge	Paint Int.	
Code	UL 142	Heads Secondary	12 Gauge	Weight Empty	765 lbs.
Test Pres.	5 PSI	Shell Secondary	12 Gauge	Rev.#	Date:

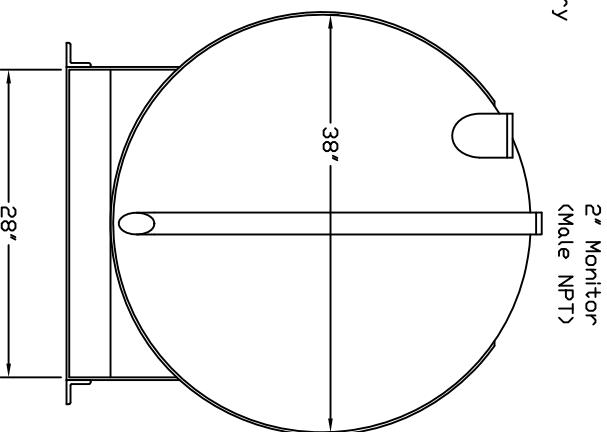
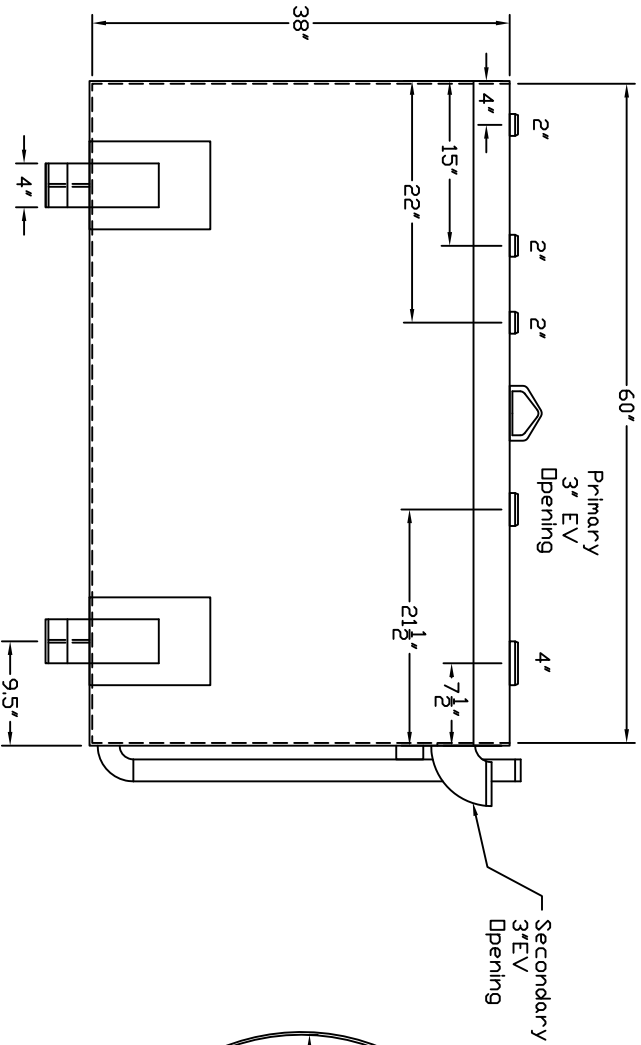
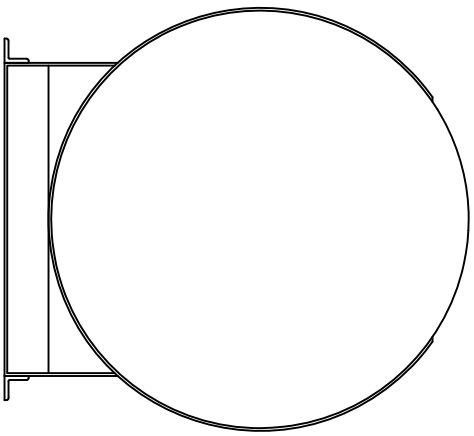

Customer: _____

Dwg. Date: _____

Drawing Approved By: _____

Quoted Lead Times Begin Upon Receipt of signed Approved Drawing, Which Must be Returned Before Production Can Begin.